

Home... away from home.

自然に抱かれた、あなたのもうひとつの住まい

Finland Village



USER'S GUIDE 2010

<http://www.finland.co.jp/village>

© K.K FINLAND VILLAGE
C-G Bystedt July 2010

FOREWORD

Welcome to Finland Village, a unique recreation facility for you, your family, friends, colleagues and clients. During the preparation and completion of the project we have tried our utmost to make this facility a functional and enjoyable place for you to stay and enjoy your vacation or to cater for business friends.

As a shareholder of our Village we hope that you always bear in mind that this is also your property. Therefore we hope that you take good care of the facilities and also encourage your guests to do so. Only by maintaining the Village in good condition we keep it comfortable and then we also manage to keep the maintenance costs low and the usage fees at a very reasonable level.

On the next pages we have explained in detail about the Village and its functions. We hope that this would guide your stay in Finland Village. Some of the information might look complicated but once you have studied it carefully we believe that you understand how everything works. And all the rules are there just to make the use fair for each shareholder and to enable all to use the facilities at regular intervals.

Whenever you have any comments about the contents of this guide, please do not hesitate to contact any of the board members listed later in this guide. Also all comments about the functions, or if so, malfunctions in the Village are always welcome.

Enjoy your stay!

Finland Village Board of Directors

1. General information about Finland Village	
1.1. Background	2
1.2. Purpose.....	3
1.3. Shareholders.....	4
1.4. Board of directors.....	5
1.5. Facilities.....	5
2. Reservation system	
2.1. Usage rights.....	6
2.2. Definition of shareholder.....	6
2.3. Reservations.....	7
2.4. Cancellations and change of reservations.....	7
2.5. Use by non-shareholders.....	7
3. Fees and Payments	
3.1. Usage fees.....	8
3.2. Payment of fees.....	8
4. Usage system	
4.1. Check-in and check-out times.....	9
4.2. Reception functions.....	9
4.3. Management office and its functions.....	9
5. General Principles for Users	
5.1. Rules.....	10
5.2. Responsibility.....	10
5.3. Order and cleanness.....	10
6. Facility information	
6.1. Parking.....	11
6.2. Keys and security.....	11
6.3. Telephone and fax	11
6.4. Kitchen	11
6.5. Saunas	11
6.6. Central vacuum cleaners.....	12
6.7. Heating system	12
7. Concert Hall functions	
7.1. About the concert hall.....	12
7.2. When could you use the hall.....	12
7.3. Practical information regarding use.....	12
8. What to do around Koumi	
8.1. Tennis.....	12
8.2. Golf.....	13
8.3. Skiing.....	13
8.4. Hiking.....	13
8.5. Fishing.....	13
9. Shops, Restaurants and Accommodation	
9.1. Shops.....	14
9.2. Restaurants.....	14
9.3. Accommodation	14
10. Contact Information	
10.1. Reservation Office.....	14
10.2. Reception.....	14
10.3. Management Office.....	14
10.4. Catering Services.....	14
10.5. Emergency Numbers.....	15
Enclosures	
Maps and drawings	16

1. General information about Finland Village

1.1. Background and history

The first idea to create Finland Village came up during a golfing trip in October 1990 to Tochigi when Mr. Peter Gronqvist of Outokumpu and Mr. Rauno Sirola of Vaisala complained about the problems to find suitable recreation facilities for their staff. Mr. Clas-Goran Bystedt from the Trade Office at the Embassy of Finland noted this and when discussing with people from Honka Japan who is representing Europe's largest log house manufacturer, Honkarakenne, about promoting log house business in Japan, the two ideas combined into the Finland Village concept.

The ideas were developed during spring 1991 and in autumn the same year, a survey was made among Finnish companies established in Japan. This survey showed enough interest in the idea and the plans were developed further and in March 1992 the marketing of shares was initiated. It had been decided that the project would be run on a time-sharing basis in the form of a limited company, *Kabushiki Kaisha*. When K.K. Finland Village was registered in October 1992 the share capital was 43 million yen, enough to go ahead with the first phase project.

The search for a suitable site for the village had been going on for a while before the site in Matsubara-ko, Koumi-cho in Nagano-ken was found. This was regarded as a very suitable location with peaceful nature and a lot of recreational activities nearby. A lease agreement was signed with Koumi-cho in October 1992 for the site of more than 6 000 sq.m.

In December 1992 the order for two houses, a main building called *Hongisto* and log cabin named *Mustikka* was made. The kit for the log cabin was delivered in May 1993 and the main building in August. A serious set-back for the project, which delayed the original schedule of completing the first phase of the village by December, was the fire that destroyed the almost completed log cabin end of October, most likely the work of an arson.

Despite this unfortunate event the board decided to go ahead with the project, partly because of the strong support from Koumi, both public and private. A new remodeled log cabin, *Mustikka ver. SB*, was ordered and delivered early February 1994. Meanwhile the construction work on the main building was at full pace and it was completed end of March 1994. In April the new *Mustikka* was completed and thereby also phase one of Finland Village. The official opening ceremony for Finland Village, including the concert hall built by Koumi-cho, was held on 4th of June 1994.

Even if Finland Village is ready it does not mean that the project is over. Preliminary plans have been made for phase two and three, adding more log cabins and other facilities to create a true village. The schedule and extent of the extensions are pending further sales of shares.

Apart from Mr. Bystedt the main player in developing the project have been Mr. Marko Saarelainen of Honka Japan who has spent so much more time on this project than ever could be expected of a supplier. Mr. Ilkka Laukkonen (at that time at KOP Tokyo Office) has though us both realism and financial know-how and Mr. Ilpo Kaislaniemi (at that time at Ahlstrom Japan) has brought his wide network and experience from a long stay in Japan to the project. Mr. Tsuyoshi Fukuda assisted by Mr. Hiromitsu Yamakawa, both from Fukuda, Nakagawa, Yamakawa Law Office have taken care of a legal matters in the project with great expertise and kept on the right side of the thin line representing right and wrong in running this kind of operation in Japan.

The construction work has been handled by Inoue Kensetsu headed by Mr. Ichiro Inoue with great enthusiasm and cooperative spirit. Mr. Hifumi was the site manager, utilizing all his inventiveness

and experience in log house construction that he has learned in Finland. Mr. Oikawa acted as supervisor being also with great competence in charge of building permits. Last but not least and often only in the background, Riitta Oikawa. She found the site and she has shown great diplomacy in mediating between stubborn and clumsy Finns and the community in Koumi. Ms Oikawa has also brought many ideas about cultural and other events to be staged in Finland Village.

Finland Village would never have been accomplished without the good cooperation and support from all the people of Koumi. In this respect a special gratitude is extended to Major Haruo Tsuchihashi and Mr. Atsushi Shinohara and Mr Takuo Koshimizu for their continuous efforts to realize this project.

1.2. Purpose

The original purpose of the village, to create a high-class and still affordable recreation facility for Finns living in Japan and for the staff of Finnish companies established here is still the main idea behind Finland Village.

The company shareholders are also expected to use the facilities for business purposes, such as entertaining clients, organizing seminars, training and exhibitions, not to forget annual company travel.

Another purpose of the village is to serve as a top-class reference for Finnish log house construction, building and interior industries. For this purpose careful selection of all products used have been carried out and this has also enabled us to get, in most cases, very favorable conditions on goods delivered, including log kits. It is expected that the village would attract a lot of attention from related businesses and media.

The addition of the concert hall built by Koumi-cho makes Finland Village also an attractive venue for cultural events such as concerts and exhibitions. Thus the village further enhance the cultural cooperation between Japan and Finland.

1.3. Shareholders

In November 2004 K.K. Finland Village had 48 shareholders of which 28 are companies. According to the company's by-laws the minimum capital is 43 million and the maximum 172 million yen.

The company shareholders are as follows:

<u>Name of shareholder</u>	<u>Number of share(s)</u>
Finnair	5
Andritz-Ahlstrom K.K.	5
Nokia Japan Co.,Ltd.	5
Honkarakenne Oy	4
Inoue Kensetsu	4
Vaisala K.K.	3
Nordea Group	3
Danisco Japan K.K.	3
UPM-Kymmene Japan KK	2
Outokumpu K.K.	2
Metso Minerals K.K.	2
Kemira-Ube K.K.	2
Metso Automation K.K.	2

Thermobio Analysis Japan K.K.	2
Nakayama Sangyo Co.,Ltd.	2
Alocs K.K.	2
Elocteq Japan Co.,Ltd.	2
Finland Trade Center	1
Sandvik Toyo Co.,Ltd.	1
Finn Corporation	1
Tizer Corp.	1
Euro Design, Ltd.	1
Oji Trading K.K.	1
OMG Japan K.K.	1
Metso Paper K.K.	1

The target is to increase the share capital to 90 million yen by June 2005 which is required for the completion of phase one. Additional share increase would be linked to further development of the village through stage two and three so that the usage rights of present shareholders would not be affected.

1.4. Board of Directors

The shareholders meeting in December 2004 elected the following board of directors:

Mr. **Veli Solehmainen**, Vaisala K.K.

tel. (03) 3226-9611, fax. (03) 3226-9610

Mr. **Kimio Hashida**, Nokia Japan Co.,Ltd.

tel. (03) 3597-0200, fax. (03) 3597-0199

Mr. **Marko Saarelainen**, Honka Japan, Inc.

tel. (0555) 20-2711, fax. (0555) 20-2712

Mr. **Sakari Romu**, Finnair Tokyo

tel. (03) 3222-6992, fax. (03) 3222-6808

Mr. **Clas-Goran Bystedt**, (Representative Director), Finland House, Co.

tel. (03) 5450-7209, fax. (03) 5450-7208

Mr. **Isao Nishimura** (Auditor), Nishimura & Associates

tel. (03) 3577-3987

We kindly invite you to contact the board members whenever you want to make any comments, questions or suggestions for improvement regarding the village. For your convenience we inform you that Mr. Fukuda and Mr. Saarelainen speak Japanese.

1.5. Facilities (see also enclosed drawings)

Main building

The main building is a two-stored log building with a living area of about 300 sq.m. It is mainly to be used for larger parties and company events and is divided into two units, *Main Unit* and *Unit Two*, for flexible use also for families and smaller groups.

The main unit has a fully equipped kitchen, large dining area seating 12 persons and a extensive sauna and bath unit. A large soap stone fireplace adds to the comfortable atmosphere. On second floor there is a conference room.

The *Main Unit* has a bedroom with two beds and an office with one bed downstairs and a large bedroom with four beds and a tatami room for up to eight persons upstairs. Thus the accommodation capacity of the *Main Unit* is up to 15 persons. The office is equipped with a telephone/fax machine.

Unit Two functions independently with its own kitchen and bathroom. A bedroom with two beds and a bedsofa in the large living-dining area make this unit suitable for four persons. The unit has its own telephone/fax machine.

In all the main building accommodates 19 persons.

Log Cabin Mustikka (Finnish for *blueberry*)

The log cabin has a living area of 60 sq.m. with own sauna and a fully equipped kitchen including dishwasher and Finnish design tableware. Two bedrooms, one with two beds and the other with a double bed and a living room equipped with a bed-sofa for two makes the cabin most suitable family accommodation for up to six persons. The terrace, dining and living room have all a great view over lake Choko to the Yatsugatake mountain range.

The log cabin has its own telephone/fax machine.

Concert Hall

The concert hall is sponsored and constructed by Koumi-cho, mainly for cultural events but the shareholders have also access to the hall for occasions larger than the main building can house, such as seminars, exhibitions and receptions.

The hall seats 200 persons in flexible arrangements.

International Park

The park is also sponsored and built by Koumi-cho. Combining Japanese style garden with European look park it incorporates a bell tower, pier to the lake and a grill shelter. The main purpose of the village is to give the citizens of Koumi to get acquainted with the village and to meet Finnish people.

2. Reservation system

2.1. Usage rights

1. Each share entitles to **50** usage points per year, 25 for each 6 months period. Points cannot be transferred from one period (e.g. six months period or year) to another.
2. Points used will be calculated according to the usage points chart below specifying points for each unit per day.
3. Usage during holidays (weekends, Japanese public holidays and Christmas) will be multiplied with **1.5**.
4. **Short notice usage**, i.e. reservations made less than one week prior to usage entitles to 50% deduction in calculation of points. I shareholder has used all his points, he would still be able to use the facility.

Used facility _____	Usage points	
	Weekdays	Holidays
All village	10	15
All of main building	7	10.5
Main unit	5	7.5
Unit Two	2	3
Log Cabin Mustikka	3	4.5

Examples:

A shareholder owning one share could use the facilities each year as follows

- Ex. A. Mustikka for 17 weekdays or 6 holidays and 8 weekdays
- Ex. B Unit 2 for 25 weekdays or 8 holidays and 13 weekdays
- Ex. C Main unit for 4 holidays and Mustikka for 7 weekdays

or (e.g. for companies, note: **per share**)

- Ex. A All village 5 weekdays per year
- Ex. B Main building for 5 weekdays and Mustikka for 3 holidays

Transfer of points

1. Shareholder can transfer usage points, but only to another shareholder.
2. The shareholder who transfers his rights have to inform the reservation office of such transfer
3. Any compensation for such transfer should be agreed upon between the shareholders.

2.2. Definition of shareholder

In this context, as shareholders are considered:

1. Legal (registered) shareholder
2. The family members of a private shareholder
3. Employees of a company shareholder.

2.3. Reservations

1. Reservations can be made online at our web site at <http://www.finland.co.jp/village/> or by fax on the enclosed form and sent to the reservation office (Finland House, Co.), fax. no. (03) 5450-7208. Prior to sending the fax-reservation, you could check availability on the web site or by phone, tel. (03) 5450-7209.
2. Upon receiving the reservation application, K.K. Finland Village confirms the reservation normally the same day.
3. With the confirmation there calculation of the usage fee which is payable one week prior to usage.
Otherwise the reservation would be void.

2.4. Cancellations and change of reservation

1. Cancellations without charges could be made one month prior to planned use.
2. For cancellations less than one month but more than one week prior to reserved date, a cancellation fee of 5 000 yen would be collected.
3. Cancellations made less than one week before reserved day would be charged 50% of the actual cost for usage and the shareholder would loose points as if he would have used the facility.
4. Change of reservations could be made within one week from planned use without cost if facility is available for the new date.

2.5. Use by non-shareholders

1. Non-shareholders could make reservations for the facilities one (1) week in advance.
2. Only in exceptional cases such reservations would be accepted for holidays.
3. Non-shareholders have to pay full fee prior to usage. If canceled, there would be no refund.

3. Fees and Payments

3.1. Usage fees 2010

<u>FACILITY</u>	<u>Weekends/holidays</u>	<u>Weekday</u>	<u>Non/shareholders</u>
Main building			
Basic Fee	32 000	22 000	50 000
Fee per person	2 500	2 500	2 500
Children - 12 years	1 500	1 500	1 500
Unit 2			
Basic Fee	6 000	4 000	10 000
Fee per person	2 500	2 500	2 500
Children - 12 years	1 500	1 500	1 500
Log Cabin Mustikka			
Basic Fee	12 000	8 000	20 000
Fee per person	2 500	2 500	2 500
Children - 12 years	1 500	1 500	1 500

Note: If you stay more than one night, you get a 10% discount for the consequent days.

When deciding the price of usage, the guests of shareholder would also be considered as shareholders. This requires however that the shareholders, as defined above, would use the facility simultaneously and carry all responsibility towards K.K. Finland Village.

3.2. Payment of fees

1. All payments are paid to K.K. Finland Village bank account (Mitsui-Sumitomo Bank, Hibiya Branch 632-6800399).
2. The usage fee is paid one week prior to use.
3. Other charges, such as telephone and fax costs, would be invoiced separately.

NOTE: In case you use the village privately (when your company is shareholder), and pay usage fee in your own name, please also give your name when making reservation, e.g. Finnair/Suzuki. Otherwise it is very difficult to check the payments against reservations.

4. Usage system

4.1. Check-in and check-out times

The check-in and check-out times follows the general rules in the industry. However we have tried to make them as flexible as possible, taking into account the time need for cleaning the facilities between users. The rules are:

1. Check-in time at the village is normally 14.00 and check out 10.00.
2. If the requested facility is available earlier (i.e. no booking for previous day), earlier check-in would be available, however no earlier than 9.00 (need to be confirmed).
3. If the facility is available (i.e. no reservation for next day) later than normal check-out time, the facility could be kept until 12.00. After this a surcharge will be applied, 25 % until 16.00, 50 % until 21.00.

NOTE: In case you arrive late, i.e. after 21.00, please inform the reception, tel. (0267) 93-2220.

4.2. Reception functions

The Finland Village Reception is located at Y-Shop Yamazaki which is located at Matsubaka-ko main junction (see map). The reception is taking care of check-in and check out functions, but also matters related to the maintenance could be handled through the reception.

1. When checking in, you will receive keys for facilities reserved and sign for the keys. No other registration is required.
2. At check-out you would leave the keys at the reception,.

4.3. Cleaning and maintenance functions

The cleaning is handled by M.R.G.. Their main tasks are:

1. General maintenance, refueling, etc.
2. Cleaning of the facilities
3. Change of sheets, towels, etc.
4. Laundry
5. Emergency repairs

If you find any malfunctions in the facilities, i.e. burnt out bulbs, toilets out of order, items missing or broken, please make a note and give it to the reception or inform M.R.G. (tel: 0267-93-0080)

5. General Principles for Users

5.1. Rules

Taking into account that Finland Village is located in a very peaceful location and that there are people living nearby it is essential that everyone using the village would respect these facts to maintain the good image that Finland Village has among people in Koumi. This does not require any extraordinary efforts or restrain your stay, just that you use some sound judgment and common sense. However we want you to remember the following guidelines:

1. Smoking is not allowed in the bedrooms, including the tatami room in the main building.
2. It is allowed to keep cats and dogs in the facilities but please observe that they do not damage furniture and textiles and that they do not enter facilities used by others.
3. Avoid using loud noise outside the buildings, especially after 22.00.
4. If you share the main building with some other party, the above applies also inside the main building.
5. Don't go, e.g. after sauna bath, outside the buildings undressed.
6. Swimming in the lake is not permitted due to risks involved and practice in Japan.
7. Don't make open fire outside.
8. To save energy, don't leave lights on when leaving the building and turn off the heaters.

5.2. Responsibility

The shareholder that has made the reservation is responsible also for his guests and might be liable to compensate damages he or his guests might inflict on the property or items missing.

5.3. Order and cleanness

It is the responsibility of each shareholder that uses the facilities to maintain them in good order and clean, this is not only to ensure a comfortable stay at the village for future users but also to keep the maintenance costs at reasonable level. As the maintenance office cleans the facilities and changes sheets and towels only when new users arrive (except in the case the stay exceeds 3 days), it is essential that you keep the facilities in good order and clean during your stay for your own comfort. For this purpose we have installed central vacuum cleaners in all facilities. All units are also equipped with dishwashers.

We hope that you could remember the following matters:

1. Use only slippers (or socks) inside the buildings.
2. Don't litter, if you have parties outside, bring in all garbage or dispose them in bins provided.
3. Don't leave perishable food (meat, vegetables, etc.) in the kitchen. Separate waste in the three garbage bins provided, combustible, non-combustible and food waste.
4. Don't bring any skis or snow-boards inside the buildings.

6. Facility information

6.1. Parking

There are three parking areas available for users of the village, see map. Use primarily the Main Parking (for about 30 cars) and only when these are occupied the Concert Hall Parking (for 10 cars). Do not block cars already parked in the area. Even if Japan is a safe country, do not leave valuables in the cars as the areas are not guarded. Parking is free of charge.

In case you have a lot of luggage, you could drive the car next to the houses, but please drive carefully and do not drive on the lawn. After unloading the car, please drive it to the parking area.

6.2. Keys and security

Each unit has its own keys, please be careful not to lose them. However if this happens, call the reception office for help. Never leave the facilities unlocked when you leave the buildings, even for a shorter time. Ensure that the terrace doors are also locked and all windows closed.

6.3. Telephone and fax

For your convenience each unit is equipped with a combined telephone and fax machine. The numbers are:

Main Unit	(0267) 93-2332
Unit Two	(0267) 93-2331
Mustikka	(0267) 93-2333

There is a money box and a telephone charge chart next to each telephone in the village. For **domestic calls**, please refer to chart for cost of your call and put money in the box. The box is open, in case you need change.

International calls will be charged afterwards according to actual cost after we have received invoice from telephone operator.

The telephone in the Main Unit is located in the office.

6.4. Kitchens

All kitchens are fully equipped with pots and pans, cutlery and tableware for those who would like to do their own cooking. For safety reasons and practicality the cookers and ovens use electricity. If you prefer to be catered for, we provide a list of caterers (see section 11.).

6.5. Saunas

The Main Unit and Mustikka is equipped with saunas. The stoves are turned on from the sauna control unit located outside the sauna room. For full power on the main sauna in Hongisto, turn on both switches on the panel. Please allow about 40 - 50 mins. For the stoves to heat up. After using the sauna, always remember to switch off the stove. For more detailed information about the use of saunas, see sign boards provided in the sauna.

Unit Two does not have its own sauna. To allow users of this unit (when not used together with Main Unit) to use the sauna we have reserved time between 18.00 and 19.00 for Unit Two, unless the users of the units agree differently.

6.8. Heating system

There are two different kinds of heaters in the Village. We have tried to combine energy efficiency with ease of use as far as possible. The heaters are as follows:

Fireplace

Located in the Main Unit the soap-stone fireplace provides heat for the main part of this unit. Please note that you should only put 3-4 loads of wood in the fireplace, this is enough. Once heated it would stay warm for 24 hours. Excessive heating only damages the fireplace.

Firewood is placed on the terrace in front of Unit 2. Always keep 2-3 bundles of wood inside the house to keep the wood dry. Before making a fire, please check that the chimney shutters, one on the fireplace, another upstairs in the conference room, are open. Don't close the shutters before the fire is totally out. Always keep the front doors of the fireplace closed.

Electric and oil heaters

There are electric heaters in each bedroom and an oil stove in the living areas. Because of the high price of electricity, use only when necessary. Due to an overload of the electric supply system, the fuses might switch off if all heaters are used simultaneously. If this happens, please switch on the automatic fuses located on the electric main board (for Hongisto located in the sauna dressing room).

7. Concert Hall

The concert hall, built by Koumi-cho on the Finland Village site is administrated jointly by Koumi-cho and Finland Village. The Hall is mainly for public events and festivals but as there would be a limited number of such events, most of the time the hall would be available for use by Finland Village shareholders. For administrative reasons the hall could, however, be used only in connection with using the village. For use of the hall there is a small maintenance charge.

The hall seats about 200 people in free formation. The chairs could be removed if a larger open space is required. It has a stage and is equipped with some audio-visual equipment.

The maintenance fee is invoiced by Koumi-cho.

Please check availability and make reservations with Koumi-cho, tel. (0267) 92-4391 (Mr. Ide).

8. What to do around Koumi

Even if Finland Village at this stage does not have many own recreation facilities there is an abundance of options around Finland Village and in Koumi. To give an idea of alternatives we list the venues for main activities that users of the village might be interested in.

8.1. Tennis

There are a number of tennis courts in Matsubara-ko area and in RE-EX Resort. The closest courts are just 300 m from the village. Reservations and inquiries should be made at Daimon-kan, tel. (0267) 93-2516. Inexpensive, around 3- 4 000 yen for half-day per court.

In RE-EX there are 17 outdoor courts and 4 indoor courts. Reservation through RE-EX Tennis Club, tel. (0267)-93-2211. See maps for locations.

8.2. Golf

There is three golf courses in within 15 minutes drive from Finland Village. The golf season starts late April and continues until November, depending on the weather conditions. In addition to these courses there is a Putter Golf course along the road leading to RE-EX Resort city. Further information about each course, for locations, see maps.

RE-EX COUNTRY CLUB

An excellent full 18-hole course, the best in the area. Reservations at the club, tel. (0267) 93-2231, mention that you belong to Finland Village. Reservations on weekdays, should not cause any problems, play on weekends might be restricted during high-season. Green fees including cart fee 8,000 – 16,000 yen depending on season and day of week.

YATSUGATAKE KOGEN COUNTRY CLUB

Also a full 18-hole course. On an altitude of 1 500 m this is one of the highest located courses in Japan. An abundance of birches gives this course an almost Finnish feeling. The course is interesting and in very good conditions. Easy to get reservations on weekdays, play on weekends might be restricted during high-season (mid July until end of August). Green fees including caddie fee: 16 - 22 000 yen depending on season and weekday. Tel. (0267) 93-2011.

KOUMI KOHGEN GOLF COURSE

A 9-hole course public course offering inexpensive golfing. Additional 9-holes planned. Green fees: 6 000 – 10 000 yen for 18-holes. Tel. (0267) 92-1990, fax. (0267) 1993.

8.3. Skiing

The closest ski area is in RE-EX Resort about 10 mins. Drive from the village. Ski season starts around second week of December and continues until beginning of April, depending on snow conditions. Five ski lifts and six courses offer a variety of skiing for all levels of skiers. Snowboarding is allowed in some of the slopes. For further information, contact Koumi RE-EX Ski Valley, tel. (0267) 93-2134.

8.4. Hiking

The Yatsugatake mountain range is famous for good hiking and mounting climbing and there are marked courses for all levels of hikers from forest hiking to Akadake peak reaching almost 3 000 m. The closest courses starts only 10-15 mins drive form the Village. The best hiking season is from June until September. Some hiking maps are available in the main building.

8.5. Fishing

Lake Choko, in front of the village, and lake Matsubarako offers opportunities for those interested to catch their own food, both in summer and winter. One-day fishing permit fees are normally collected at the lake.

9. Shops, Restaurants and Accommodation

9.1. Shops

The shop closest to Finland Village is Shimaya Y-Shop (the Reception) which is a fairly well equipped convenience store, including some alcoholic beverages. The shop is located at the main junction in Matsubara-ko (were you turn left for Finland Village) and only about 300 m from the village. Open every day from 10.00-20.00

For more “advanced” shopping we recommend that you go to the center of Koumi-cho, or visit the supermarket about half-way to the center.

9.2. Restaurants

There are seven ryokans in Matsubara-ko which all offer restaurant services (see map). Miyamotoya ryokan, tel. (0267) 93-2432, is a good alternativ for dining close to the village. Note that reservations should always be made at least one day in advance.

In addition to these the RE-EX Resort Hotel, tel.. (0267) 93-2211, offers high-class restaurant services.

9.3. Accommodation

In addition to the establishments mentioned above there are in all 31 minshukus only in Matsubara-ko. This means that if the capacity of Finland is not enough for your needs there are many alternatives available.

Recommendable facilities are Miyamotoya ryokan, tel.. (0267) 93-2432 , Matsubarako Kogen Hotel, tel.. (0267) 93-2723 and RE-EX Hotel , tel.. (0267) 93-2211.

10. Contact Information

10.1. Reservation Office

Address: c/o Finland House, Co.,
2-33-20-203, Tsurumaki, Setagaya-ku, TOKYO 154-0016
Tel. (03) 5450-7609, Fax. (03) 5450-7608

10.2. Reception

Address: c/o Y-shop Yamazaki (Matsubarako Shimaya Shoten)
Matsubara-ko, Koumi-cho, Minamisaku-Gun, Nagano-ken 384-1103
Tel.: (0267) 93-2220, Fax: (0267) 93-2975

10.3. Management Office

Address: Finland House, Co
2-33-20-203, Tsurumaki, Setagaya-ku, TOKYO 154-0016
Tel. (03) 5450-7609, Fax. (03) 5450-7608

10.4. Catering Services

We have agreed that the below listed establishments would provide catering services to the village. Please allow at least two hours for preparations and delivery.

<u>Establishment</u>	<u>Type of food</u>	<u>Telephone</u>
Matsubarako Kogen Hotel	Any kind	(0267) 93-2723
Miyamotoya Ryokan	Japanese	(0267) 93-2432

10.5. Emergency Numbers

POLICE	110	(nearest police box 0267-92-2057)
AMBULANCE	119	(nearest hospital 0267-92-2077)
FIRE STATION	119	(Koumi fire station 0267-92-2872)
TAXI	0267-92-2133	

11. Maps and drawings

11.1. Access map to Finland Village



By Car

- 180 km from central Tokyo
- Chuo Expwy to Sutama or Nagasaka I.C.
- Kanetsu-Joshinetsu Expwy to Saku I.C.
- ca 3 hours depending on traffic

By train

- A. Nagano Shinkansen to Sakudaira
 - Koumi Line to Koumi or Matsubarako stn.
 - Travel time: 2hours 15 min
- B. Chuo Line to Kobuchisawa
 - Koumi Line to Koumi or Matsubarako stn.
 - Travel time: ca 3 hours

11.2. Matsubara-ko area



11.3. Facilities

Main Building Hongisto

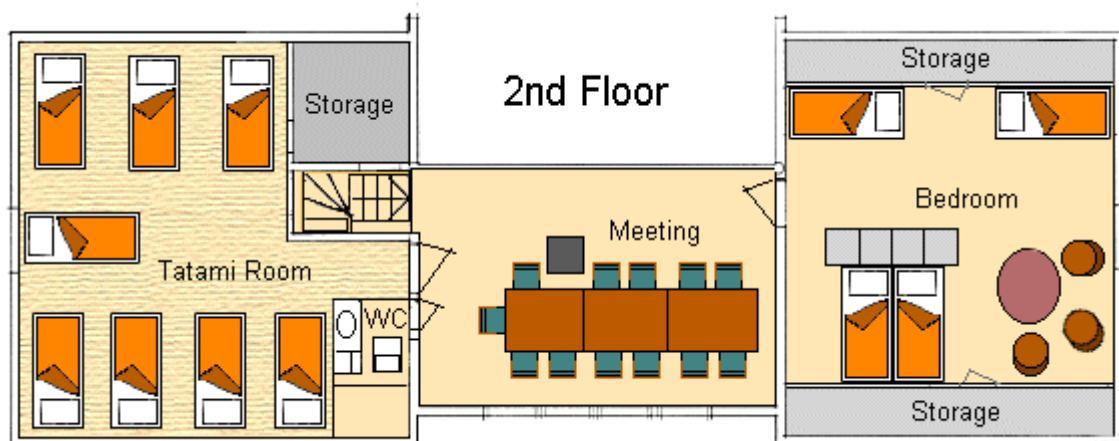

Log Cabin *Mustikka*

